



ATLAS+FYNE

FS Series Loudspeakers

UNIVERSAL MOUNT

INSTALLATION GUIDE



FS Series Loudspeakers

UNIVERSAL MOUNT



INSTALLATION GUIDE

INSTALLATION SAFETY NOTICE

1. **Fixing Responsibility:** Users are responsible for securely fixing the hardware to the surface to ensure safe operation. The fixings utilized must be capable of supporting the weight of the product. Refer to the product specification pages for the appropriate weight limits. Additionally, consult the relevant construction codes in your region for guidance on suitable hardware fixing methods.
2. **Secondary Security Measures:** Certain regional construction codes may mandate the utilization of a secondary method for securing loudspeakers to surfaces to ensure a backup support system. It is recommended to attach a secondary support line from the product to a secure point on the wall. Refer to the relevant construction codes in your region for specific requirements.
3. **Accountability:** AtlasIED will not be held liable for any damages resulting from incorrect installation procedures.

Please adhere to these safety guidelines to ensure the safe and proper installation of your product. If you have any questions or concerns, feel free to contact us for assistance.

SUMMARY OF STEPS

1. Separate swivel bracket from mounting plate
2. Remove the mounting plate cover and rubber grommet
3. Attach mounting plate to wall
4. Drill loudspeaker wire holes through rubber grommet (optional)
5. Pull wires through the mounting plate assembly
6. Feed wires through weatherproof loudspeaker back plate (optional)
7. Connect the loudspeaker wires to the Euroblock connector
8. Set transformer wattage tap
9. Attach the adjustable swivel bracket to the loudspeaker
10. Attach the loudspeaker to the wall mounting bracket
11. Connect Euroblock connector to loudspeaker and attach weatherproof back plates (optional)
12. Adjust the angle of the loudspeaker
13. Ensure "service loop" in place to prevent water damage
14. Drive locking screw through the swivel bracket and into wall bracket

FS Series

UNIVERSAL MOUNT



INSTALLATION GUIDE

INCLUDED CONTENTS/TOOLS REQUIRED

FS Series Surface Mount Loudspeakers: Included Contents/Required Tools	
PART	QTY (per loudspeaker)
Wall plate bracket	1
Swivel link bracket	1
Swivel link bracket loudspeaker connection screws (VESA), M4, 10 mm, flat head	4
Rubber grommet	1
Rubber grommet mounting plate	1
Rubber grommet mounting plate screws, M4, 10 mm, flat head	4
Bracket locking screw, M4, 10 mm, button head	1
Loudspeaker connector cover, rubber rings, nozzle caps, kit (included with FS loudspeaker)	1
Connector cover screws, M4, 17 mm, flat head (included with FS loudspeaker)	4
4-pin Euroblock connector, 5 mm pitch (included with FS loudspeaker)	1

TOOLS REQUIRED

1. Electric Drill
2. Slotted screwdriver: 3.5 mm
3. Drill bit: #1 or larger diameter bit depending on the gauge of wire used
4. Phillips head (#2) screwdriver
5. Wire strippers
6. Hex wrench: 5/32" (4 mm)

FS Series

UNIVERSAL MOUNT



INSTALLATION GUIDE

STEP 1 - SEPARATE SWIVEL BRACKET FROM MOUNTING PLATE

Firmly press the release button at the bottom of the mounting plate then pull away the swivel bracket.(Figure 1)

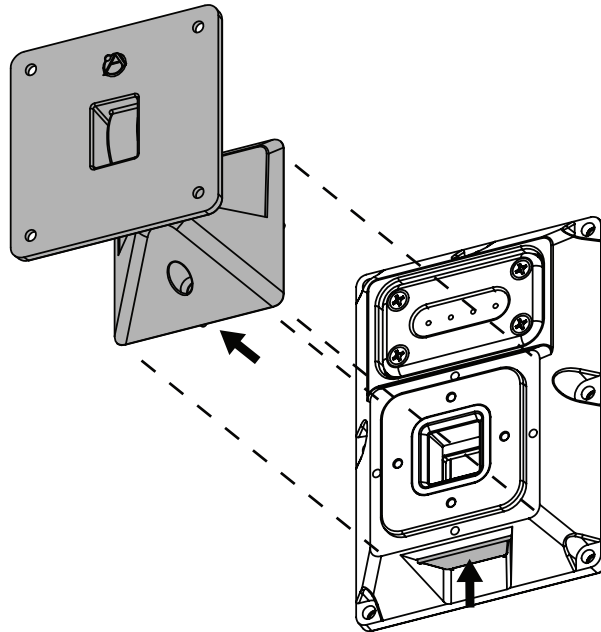

Figure 1

FS Series

UNIVERSAL MOUNT



INSTALLATION GUIDE

STEP 2 - REMOVE THE MOUNTING PLATE COVER AND RUBBER GROMMET

Using a Phillips screwdriver, remove the four (4) screws covering the grommet plate to remove both the grommet plate and rubber grommet. (Figure 2)

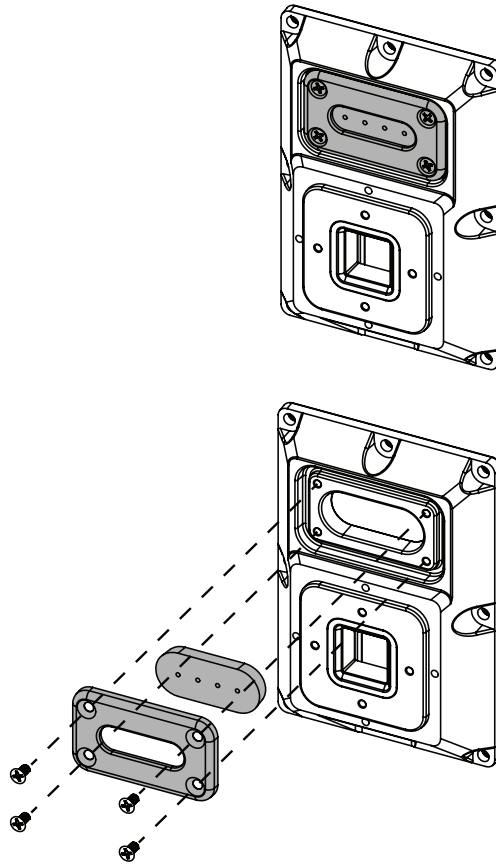

Figure 2

FS Series

UNIVERSAL MOUNT



INSTALLATION GUIDE

STEP 3 - ATTACH MOUNTING PLATE TO WALL

Mount the bracket to the wall using fasteners appropriate for the wall material and loudspeaker weight. (Figure 3) Ensure proper fasteners are used.

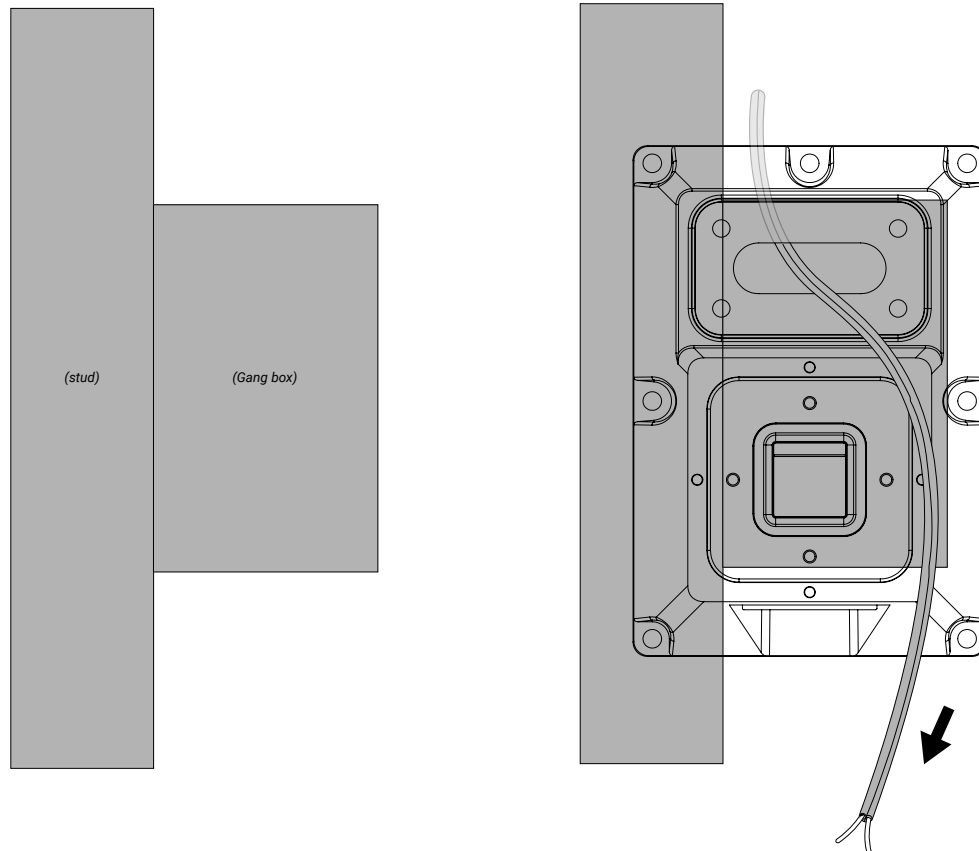

Figure 3

FS Series

UNIVERSAL MOUNT



INSTALLATION GUIDE

STEP 4 - DRILL LOUDSPEAKER WIRE HOLES THROUGH RUBBER GROMMET (OPTIONAL)

Note: This is an optional step for indoor installations, but one required for weatherproofing in outdoor installations:

- Secure the rubber grommet to prepare for drilling.
- Place a spare board behind the grommet to protect the work surface while drilling.
- Using a #1 drill bit, carefully drill through one or more of the pilot holes.(Figure 4)

Note: A #1 drill bit works for most thicknesses of cable. If it does not, use a larger diameter bit.

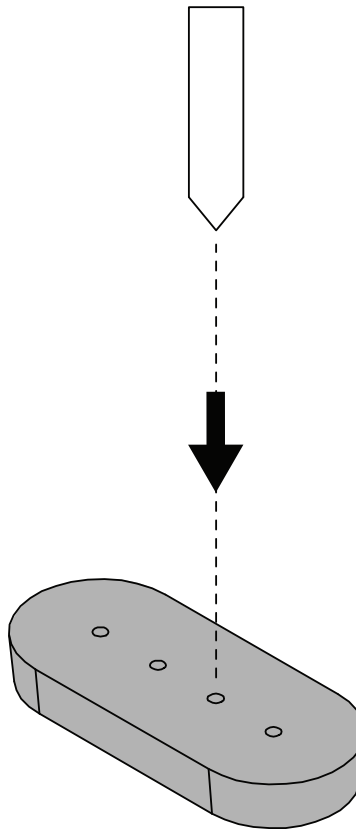

Figure 4

FS Series

UNIVERSAL MOUNT



INSTALLATION GUIDE

STEP 5 - PULL WIRES THROUGH THE MOUNTING PLATE ASSEMBLY

Pull the loudspeaker wires from inside the wall through the opening in both the wall mounting plate and the grommet plate.(Figure 5)

Optionally, feed the wire through the rubber grommet, fit in between the mounting plate and grommet plate for weatherproofing applications.(Figure 6)

Note: Wires must be unterminated before inserting through the grommet.

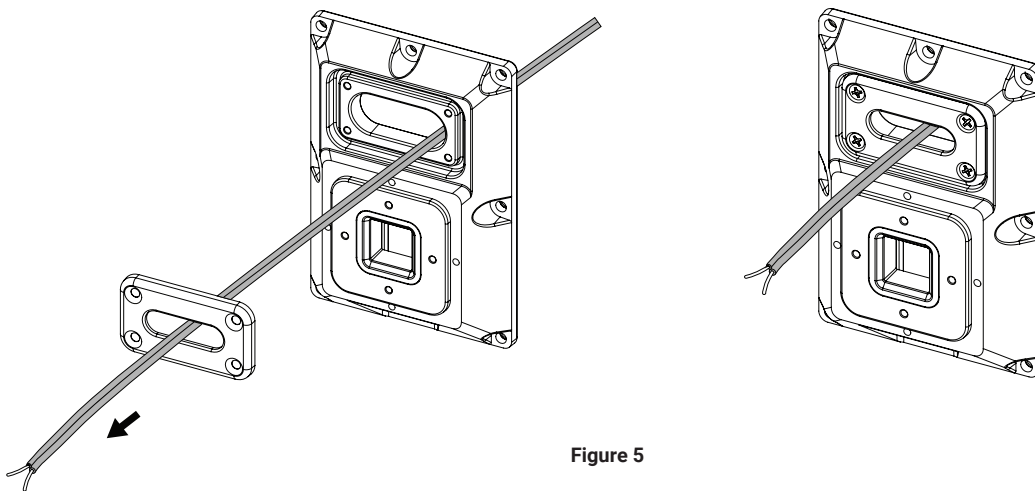

Figure 5

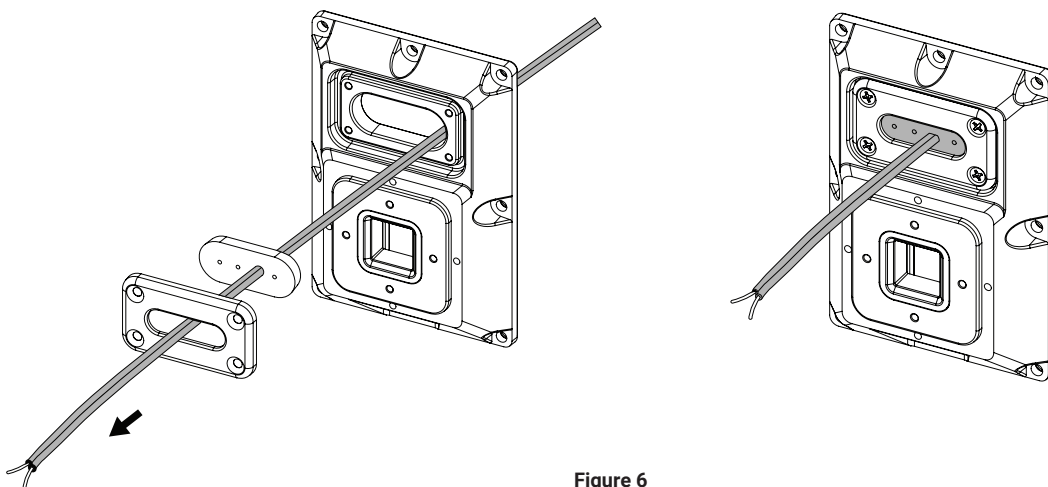

Figure 6



INSTALLATION GUIDE

STEP 6 - FEED WIRES THROUGH WEATHERPROOF BACK PLATE (OPTIONAL)

Use one of the following methods to make electrical connection to the loudspeakers for weatherproofing in outdoor installations.

Note: This is an optional step for indoor installations, but one required for weatherproofing in outdoor installations:

For indoor applications, skip to Step 7.

Method A – Threaded Nozzle

Using the weatherproof back plate, 3-part rubber plug, and nozzle cap:

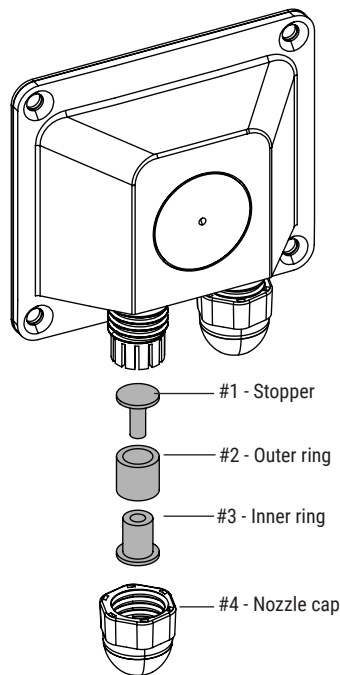

Figure 7

The threaded nozzle combined with the appropriately sized rubber ring helps seal out water from the recessed area that contains electrical connections and the wattage tap selector switch on the rear of the loudspeaker.

The 3-part rubber plugs (shipped as a single piece) can be disassembled and re-assembled as necessary to make a secure seal according to the type of connection required.

Recommendations:

- For thicker wire (12/2 or CAT5/6 cabling (5-7 mm)): Use the outer part of the plug alone (#2 in Figure 7 above) to create a weatherproof ring.
- For thinner wire (14/2, 16/2, or 18/2 cabling): Use the inner part of the plug (#3 in Figure 7 above) together with the outer part (#2 in Figure 7) to create a weatherproof ring.
- For no connection: When no connection is necessary, use the fully assembled rubber plug.

It is recommended to use the left cable passage for the input wiring from any upstream loudspeakers/amplifier and the right cable passage for downstream loudspeakers. If no loudspeakers are to be connected downstream, the right cable passage should be completely sealed with the fully assembled rubber plug.

FS Series

UNIVERSAL MOUNT



INSTALLATION GUIDE

STEP 6 - FEED WIRES THROUGH WEATHERPROOF BACK PLATE (OPTIONAL - CONT.'D)

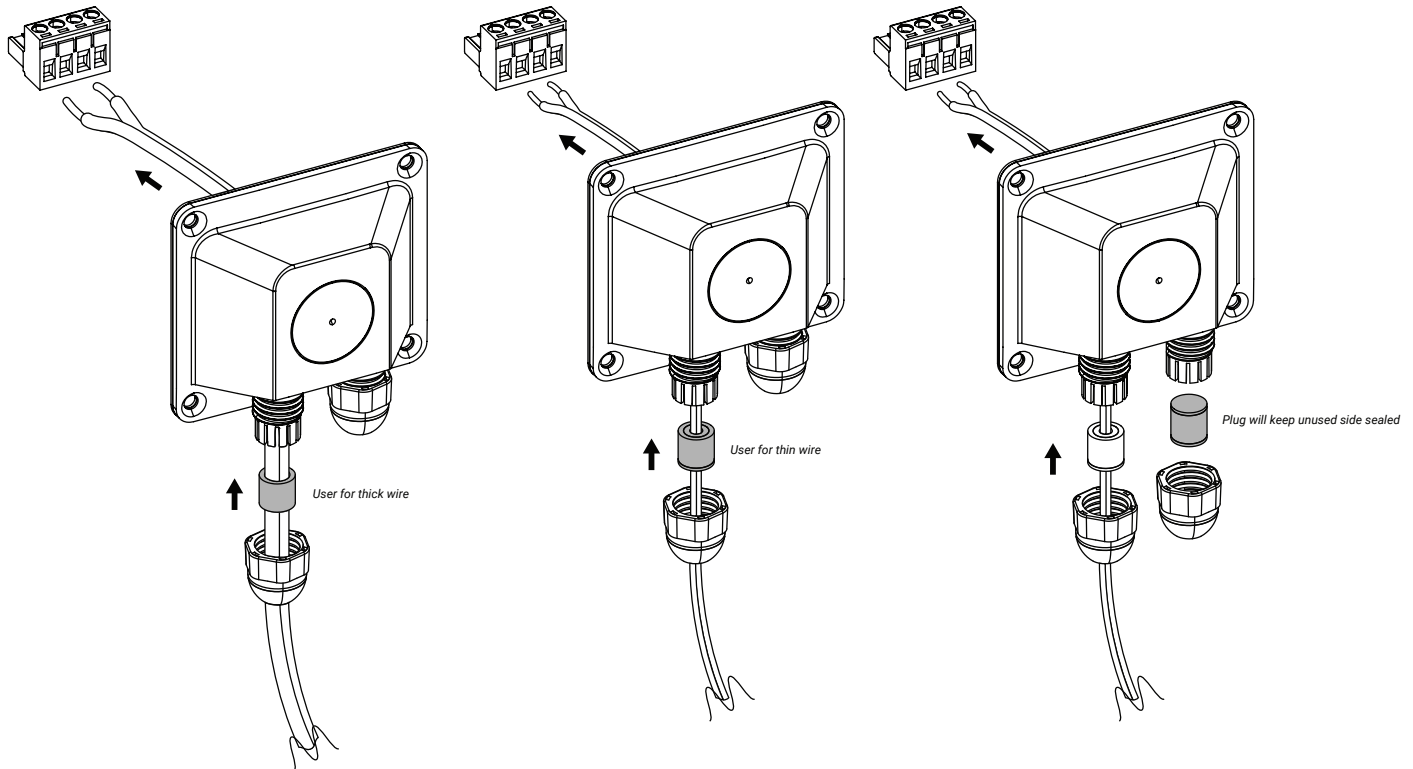

Figure 8

Feed the wire through the nozzle cap, rubber ring(s), nozzle, and into the interior of the back cover plate.(Figure 8)

Push the rubber ring(s) into the cable passage so the ring and wire fit snugly.

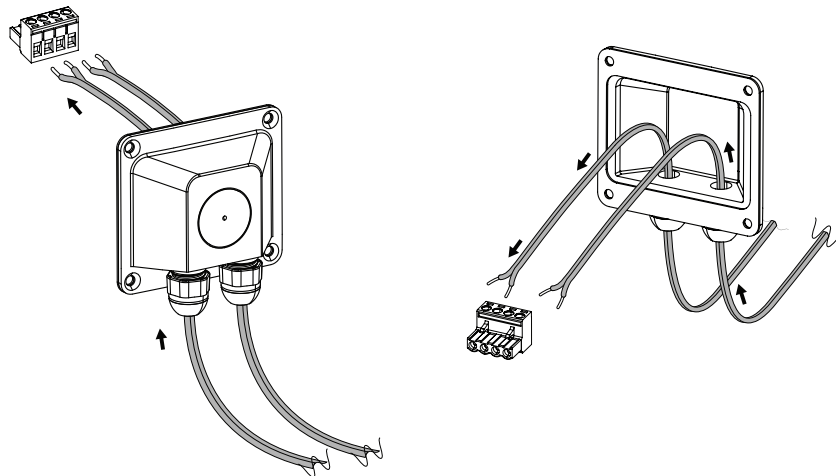

Figure 9

Pull the wire through the nozzle and into the back plate's open-space area, leaving workable slack.(Figure 9)

Partially tighten the nozzle cap so the wire remains in place. The nozzle cap will be completely tightened in Step 11(c).

FS Series

UNIVERSAL MOUNT



INSTALLATION GUIDE

STEP 6 - FEED WIRES THROUGH WEATHERPROOF BACK PLATE (OPTIONAL - CONT.'D)

Method B – Conduit

The weatherproof back plate can also accommodate conduit wiring. Drill through the back of the plate using the appropriately sized hole saw or conduit knockout punch, then attach the conduit fitting.(Figure 10)

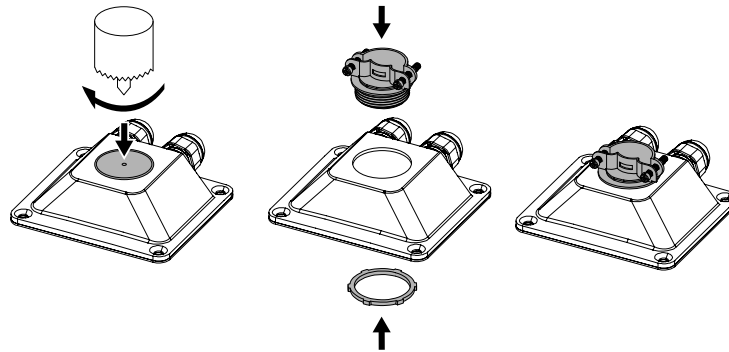

Figure 10

Plug both the cabling nozzles using the assembled solid rubber seals and tighten both nozzle caps to create the weatherproof seal.(Figure 11).

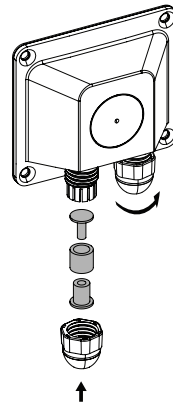

Figure 11

FS Series

UNIVERSAL MOUNT



INSTALLATION GUIDE

STEP 7 - CONNECT THE LOUDSPEAKER WIRES TO THE EUROBLOCK CONNECTOR

Strip off an appropriate amount of insulation from each wire and insert the wire into the correct pin opening on the Euroblock connector. Use a slotted screwdriver to tighten the corresponding screw to secure the wire.(Figure 12).

Connect the Input pins to the amplifier upstream. Connect the Output pins to any additional 70.7 V/100 V loudspeakers downstream or to a second loudspeaker for 4 Ω operation, if used in low impedance mode.(Figure 13).

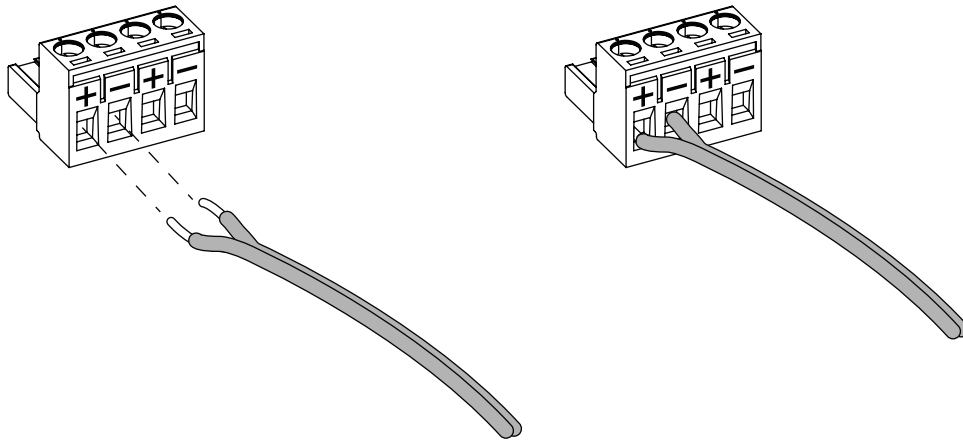

Figure 12

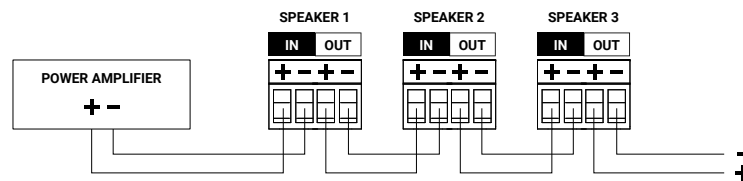

Figure 13



INSTALLATION GUIDE

STEP 8 - SET TRANSFORMER WATTAGE TAP

Determine the proper wattage setting, and slide the transformer tap switch to the desired value.(Figure 14)

Note: The 70.7 V tap settings shown on top in black, and the 100 V settings shown on bottom in white. The 8 Ω bypass setting is the leftmost setting.

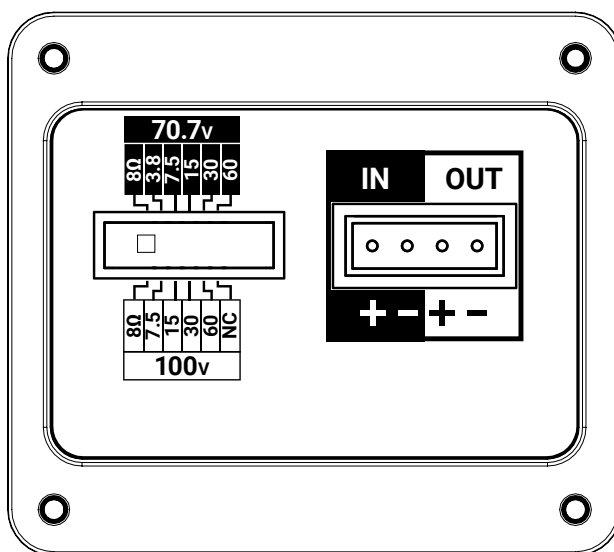

Figure 14

FS Series

UNIVERSAL MOUNT



INSTALLATION GUIDE

STEP 9 - ATTACH THE ADJUSTABLE SWIVEL BRACKET TO THE LOUDSPEAKER

Place the flat end of the swivel bracket onto the matching VESA hole pattern on the back of the loudspeaker. Use the UP arrow printed on the swivel bracket to properly align the bracket and connector. Use the four (4) included screws to secure the plate to the loudspeaker. (Figure 15).

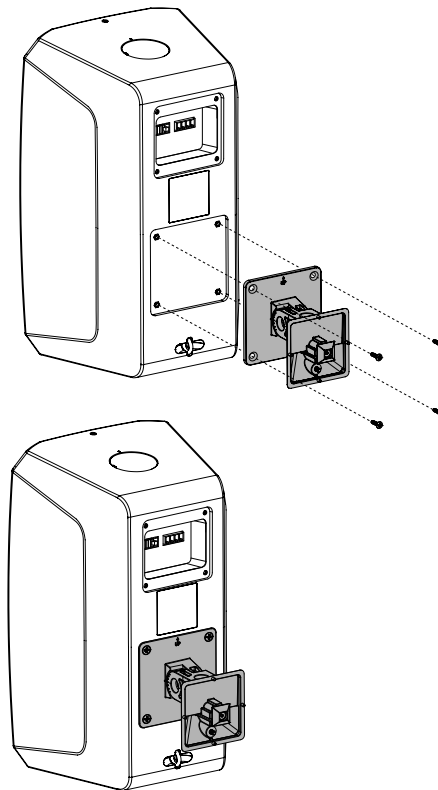

Figure 15

FS Series

UNIVERSAL MOUNT



INSTALLATION GUIDE

STEP 10 - ATTACH THE LOUDSPEAKER TO THE WALL MOUNTING BRACKET

Carefully align the swivel bracket to the mounting plate and press firmly until there is an audible click.(Figure 16)

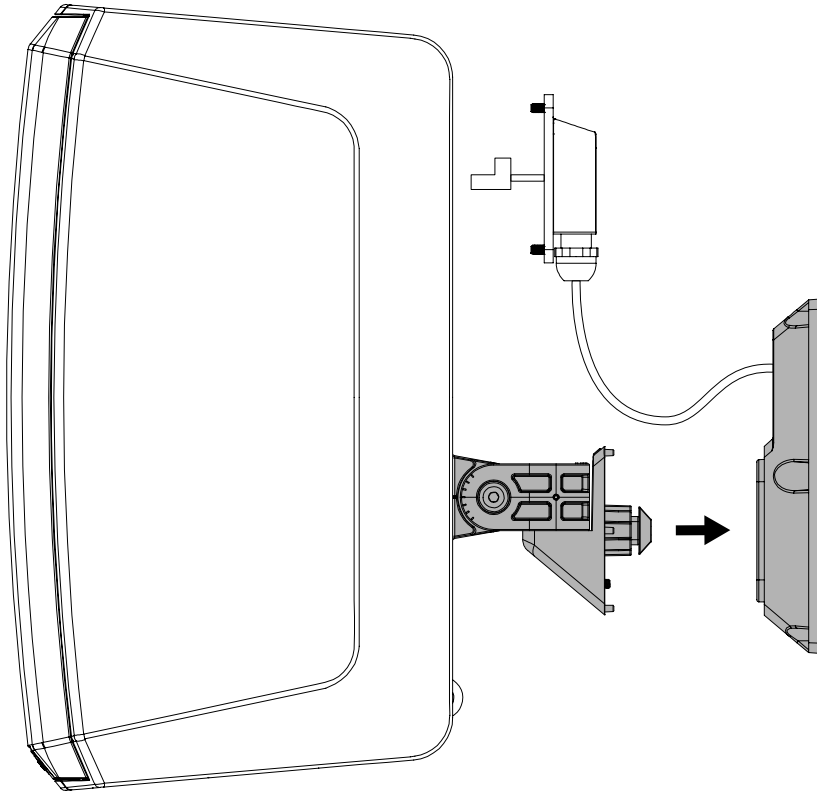

Figure 16

FS Series

UNIVERSAL MOUNT



INSTALLATION GUIDE

STEP 11 - CONNECT EUROBLOCK CONNECTOR TO LOUDSPEAKER AND ATTACH WEATHER PROOF BACK PLATES (OPTIONAL)

Connect the configured Euroblock connector to the back panel of the loudspeaker.(Figure 17)

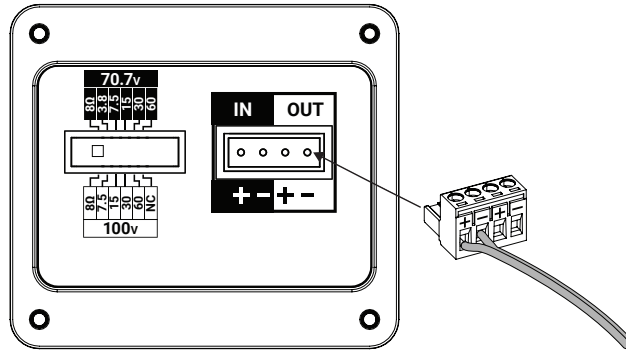

Figure 17

Note: The following is an optional step for indoor installations, but one required for weatherproofing in outdoor installations:

- Slide the back plate assembly along the loudspeaker wire until it is flush with the recessed cover opening.(Figure 18)
- Use the included screws and a Phillips head screwdriver to affix the back plate to the loudspeaker.(Figure 18)
- Tighten the cabling nozzle cap(s) until snug.(Figure 19)

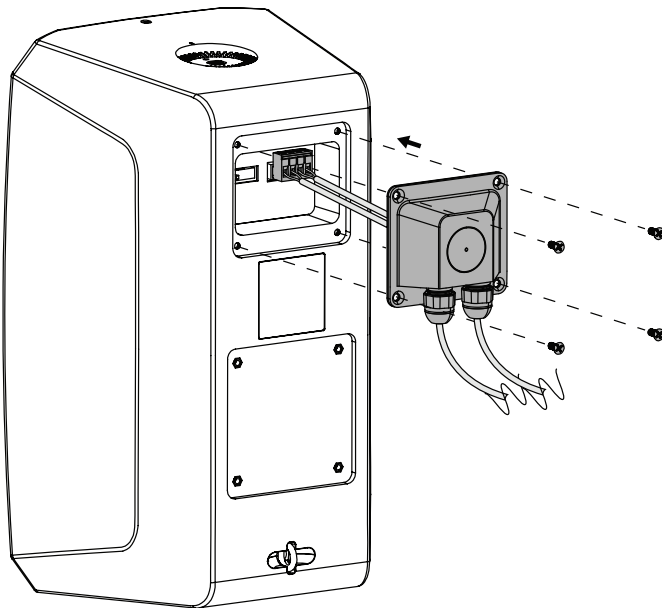

Figure 18

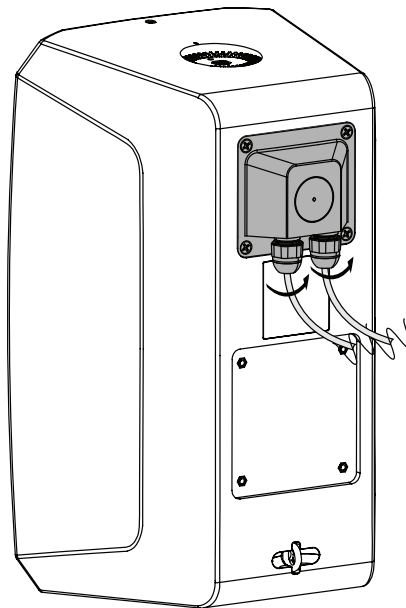

Figure 19

FS Series

UNIVERSAL MOUNT



INSTALLATION GUIDE

STEP 12 - ADJUST THE ANGLE OF THE LOUDSPEAKER

Tilt the loudspeaker to desired angle by using the angle adjustment notches provided on both parts of the swivel bracket (up/down; left/right). Partially loosen, but do not fully remove the screws shown in the figures below using a 5/32" (4 mm) hex wrench. Once adjusted to the desired position, fully tighten the screws. Use the angle guide provided on the loudspeaker bracket to help with alignment.(Figure 20)

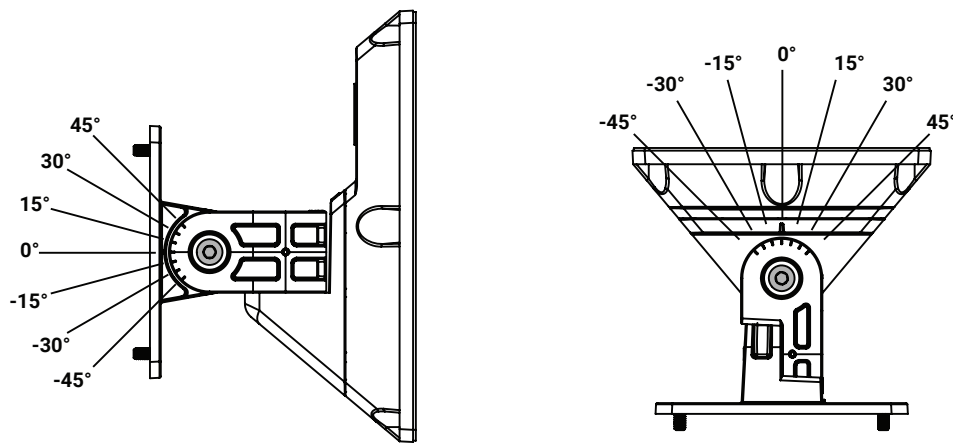

Figure 20

FS Series

UNIVERSAL MOUNT



INSTALLATION GUIDE

STEP 13 - ENSURE "SERVICE LOOP" IN PLACE TO PREVENT WATER DAMAGE

Note: This step is required for weatherproofing in outdoor installations.

Ensure that one point of the loudspeaker wire is below the point where the wire is fed through the mounting plate to create a "service" or "drip" loop.(Figure 21 - #1)
This directs water away from the service panel of the loudspeaker.

Note: Connect the safety tether from the safety ring at the bottom of the loudspeaker (Figure 21 - #2) to a structurally adequate location on the mounting surface to support the weight of the loudspeaker should it fall.

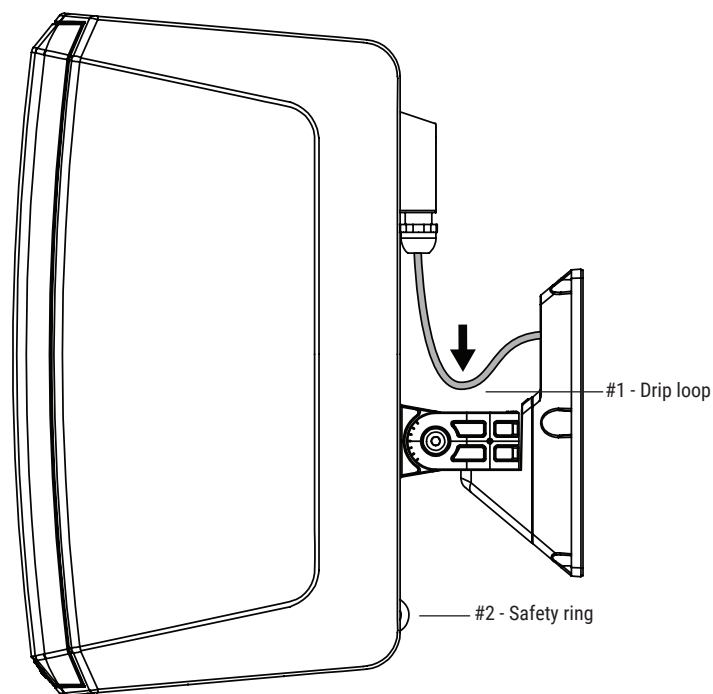

Figure 21

FS Series

UNIVERSAL MOUNT



INSTALLATION GUIDE

STEP 14 - DRIVE LOCKING SCREW THROUGH THE SWIVEL BRACKET AND INTO WALL BRACKET

Drive the locking screw through the swivel bracket and wall bracket using a 5/32" (4 mm) 90-degree hex wrench, then tighten.(Figure 23)

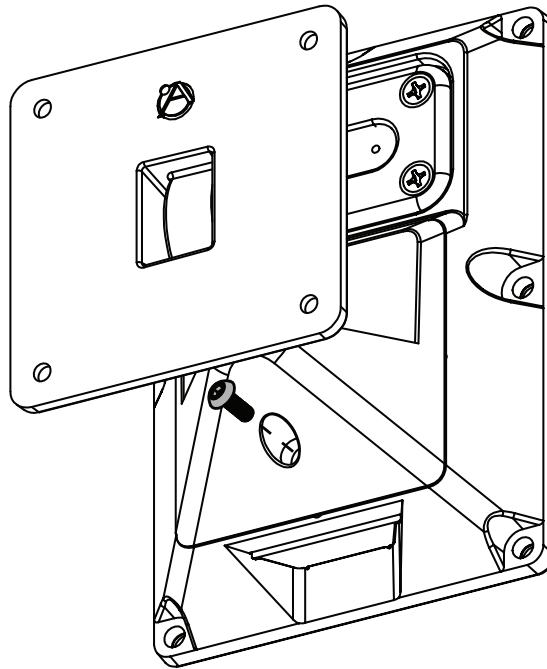

Figure 23

FS Series

UNIVERSAL MOUNT



INSTALLATION GUIDE

LIMITED WARRANTY

All products manufactured by AtlasIED are warranted to the original dealer/installer, industrial or commercial purchaser to be free from defects in material and workmanship and to be in compliance with our published specifications, if any. This warranty shall extend from the date of purchase for a period of three years on all AtlasIED products, including SOUNDOLIER brand, and ATLAS SOUND brand products except as follows: one year on electronics and control systems; one year on replacement parts; and one year on Musician Series stands and related accessories. Additionally, fuses and lamps carry no warranty. AtlasIED will solely at its discretion, replace at no charge or repair free of charge defective parts or products when the product has been applied and used in accordance with our published operation and installation instructions. We will not be responsible for defects caused by improper storage, misuse (including failure to provide reasonable and necessary maintenance), accident, abnormal atmospheres, water immersion, lightning discharge, or malfunctions when products have been modified or operated in excess of rated power, altered, serviced or installed in other than a workman like manner. The original sales invoice should be retained as evidence of purchase under the terms of this warranty. All warranty returns must comply with our returns policy set forth below. When products returned to AtlasIED do not qualify for repair or replacement under our warranty, repairs may be performed at prevailing costs for material and labor unless there is included with the returned product(s) a written request for an estimate of repair costs before any nonwarranty work is performed. In the event of replacement or upon completion of repairs, return shipment will be made with the transportation charges collect.

EXCEPT TO THE EXTENT THAT APPLICABLE LAW PREVENTS THE LIMITATION OF CONSEQUENTIAL DAMAGES FOR PERSONAL INJURY, ATLASIED SHALL NOT BE LIABLE IN TORT OR CONTRACT FOR ANY DIRECT, CONSEQUENTIAL OR INCIDENTAL LOSS OR DAMAGE ARISING OUT OF THE INSTALLATION, USE OR INABILITY TO USE THE PRODUCTS. THE ABOVE WARRANTY IS IN LIEU OF ALL OTHER WARRANTIES INCLUDING BUT NOT LIMITED TO WARRANTIES OF MERCHANTABILITY AND FITNESS FOR A PARTICULAR PURPOSE.

AtlasIED does not assume, or does it authorize any other person to assume or extend on its behalf, any other warranty, obligation, or liability. This warranty gives you specific legal rights and you may have other rights which vary from state to state.

SERVICE

Should your Atlas FS Series Universal Mount require service, please contact the AtlasIED warranty department at 1-877-689-8055, ext. 277 to obtain an RA number.

AtlasIED Tech Support can be reached at 1-800-876-3333 or support.atlasied.com.

Visit our website at www.AtlasIED.com to see other AtlasIED products.